

COMBINATION EMERGENCY SHOWERS AND EYE WASH HAND/FOOT OPERATED - STAINLESS STEEL

Enware's emergency safety showers assist in the rapid removal of contaminants from the body with a deluge of flushing fluid. Combined with a eye wash system featuring Enware's Vertex Technology. Independently tested to comply with Standards ANSI Z358.1 and AS 4775. Stainless steel construction for superior durability and reliability, choose powder coated for extra chemical resistance. Alarms and lighting systems for safety showers are available, please contact Enware on 1300 369 273 to ensure the best solution for specific site requirements.

Key features

- ✓ Stainless steel shower head and impeller, pull rod, bowl and stay open ball valves
- ✓ High visibility yellow epoxy coated activation pull rod, hand and foot pedal
- ✓ Hand or foot activated eyewash with soft aerated flow and integral auto-open dust covers
- ✓ Zero velocity apex point provides more comfort and control for effective cleansing of eyes
- ✓ Self-draining design reduces bacteria risk, particularly in tepid water applications
- ✓ Designed and manufactured in Australia



PRODUCTS

Product code	Line description
ECE090	Brushed Stainless Finish
ECE090GR	Powder Coated Finish - GREEN
ECE090OR	Powder Coated Finish - ORANGE
ECE090WH	Powder Coated Finish - WHITE
ECE090YE	Powder Coated Finish - YELLOW

DIMENSIONS

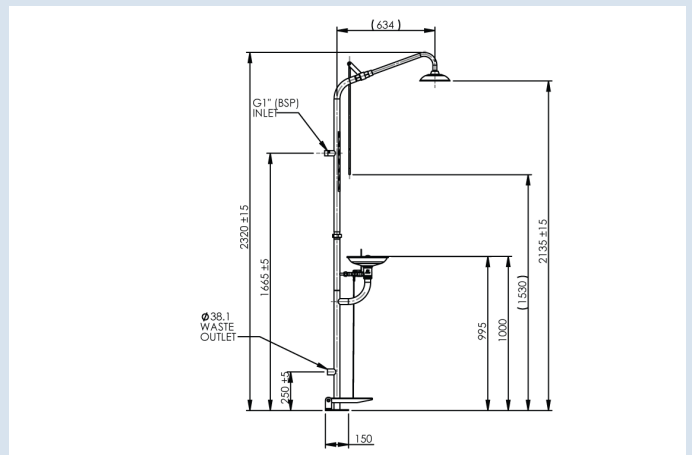

TECHNICAL INFORMATION

Inlet Connection	25 mm (1" BSP)
Water Supply Line Size	Supply piping shall be adequately sized to meet flow requirements
Minimum Performance Requirements - Min Working Pressure	210 kPa
Minimum Performance Requirements - Min Flow Requirements	76 lpm (20 US gpm)
Waste Water Outlet Size	38 mm (1-1/2") OD
Mounting Base Size	Size: 150 x 150 mm (5-9/10" x 5-9/10") with 4 Bolt Holes 11 mm (7/16")
Shipping	Weight: approx. 9 kg Dimensions: 1160 x 300 x 250 mm

† Enware products must be installed in accordance with AS4775 - Emergency Eyewash and Safety Equipment, AS/NZS 3500 - Plumbing and Drainage, and the Plumbing Code of Australia (PCA). Installations not complying with AS4775, AS/NZS 3500 and PCA may void the product and performance warranty provisions. The performance of Enware AS/NZS 3718 tapware, in many cases, exceeds the plumbing system design requirements of AS/NZS 3500 and PCA.